

5/8" PLYWOOD
SUBSTRATE

GASKA TAPE

PANEL

ADHESIVE

J MOLDING BY EWSI

SILICONE SEALANT

CAULK JOINT

BOND BREAKER

EIFS, BRICK, CONCRETE

Note: These details are general guidelines. Please consult your panel manufacture for intstall instructions for your particular panel.

Exterior Wall Systems, Inc 6530 396th Court North Branch, MN 55056 www.ewsi.us dave@ewsi.us	DRAWING NAME: BASE/FOUNDATION	
	SYSTEM:	DATE:

5/8" PLYWOOD
SUBSTRATE

EWSI DIVIDER
MOLDING

SILICONE SEALANT

PANEL

ADHESIVE

GASKA TAPE

Note: These details are general guidelines. Please consult your panel manufacture for intstall instructions for your particular panel.

Exterior Wall Systems, Inc
6530 396th Court
North Branch, MN 55056
www.ewsi.us dave@ewsi.us

DRAWING NAME:

HORIZONTAL OR
VERTICAL DIVIDER

SYSTEM:

DATE:

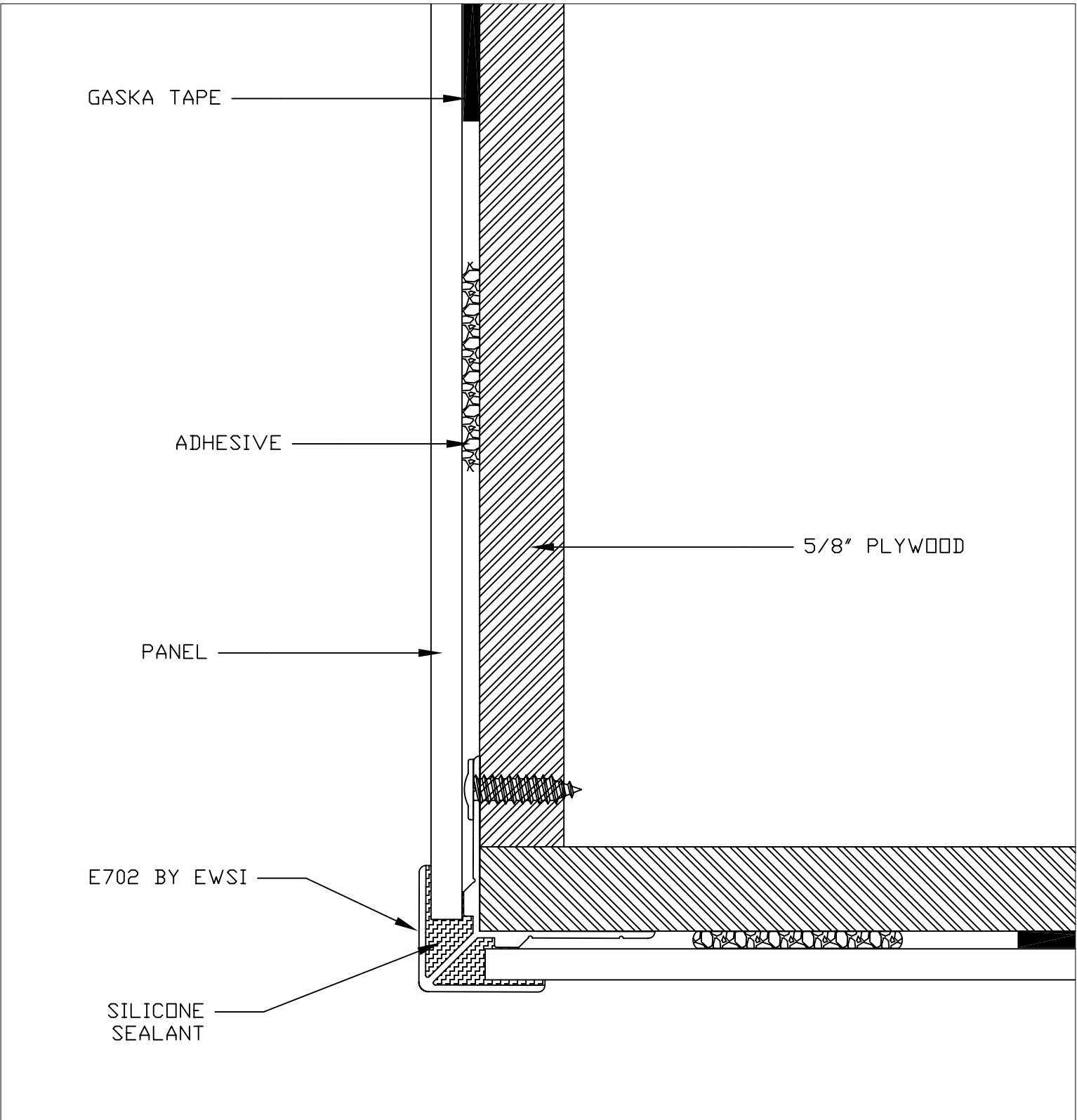

Note: These details are general guidelines. Please consult your panel manufacture for intstall instructions for your particular panel.

Exterior Wall Systems, Inc 6530 396th Court North Branch, MN 55056 www.ewsi.us dave@ewsi.us	DRAWING NAME: OUTSIDE CORNER	
	SYSTEM:	DATE:

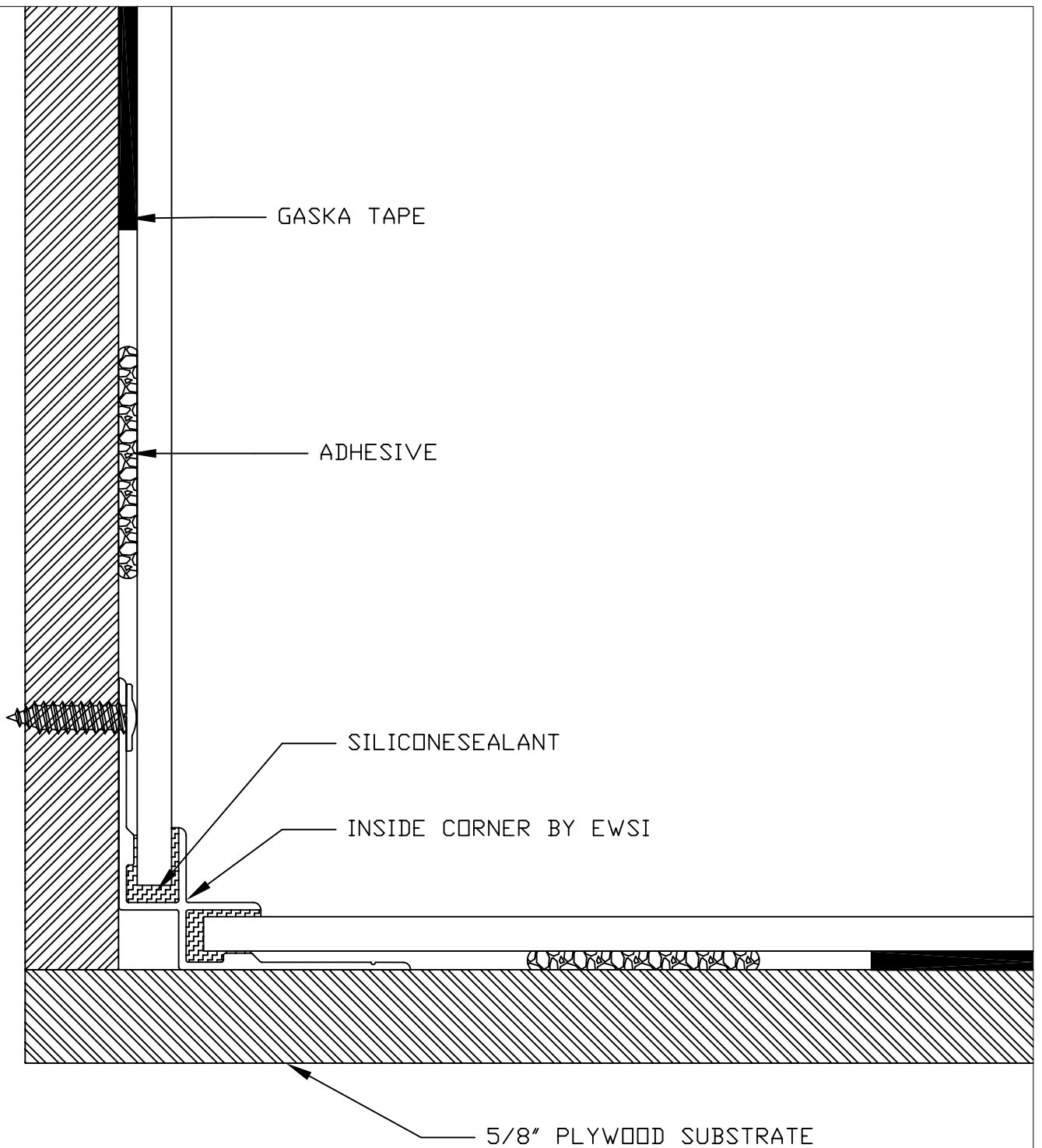

Note: These details are general guidelines. Please consult your panel manufacture for intstall instructions for your particular panel.

Exterior Wall Systems, Inc 6530 396th Court North Branch, MN 55056 www.ewsi.us dave@ewsi.us	DRAWING NAME: INSIDE CORNER	
	SYSTEM:	DATE:

